

ALLDAY
& MILLER



West End Lane, Hayes, UB3 5LU
£300,000

 2  1  1  C



West End Lane, Hayes, UB3 5LU

£300,000

- Ground Floor Maisonette
- Two Double Bedrooms
- No Service Charge
- Prime Location
- Great Investment Opportunity
- No Upper Chain
- Brand New Long Lease
- Gas Central Heating / Double Glazing
- Garage
- Garden

Description

Perfect for first time buyers or investors looking for a strong rental return. This property with great potential comprises of a welcoming entrance porch, spacious light filled reception room, fitted kitchen, family bathroom suite and two double bedrooms to complete the accommodation.

A low maintenance front garden mainly laid to lawn with a pathway leading to the property.

Situation

West End Lane just moments from the Bath Road in prime location to a number of local amenities including London Heathrow Airport Terminals 1, 2 & 3 just 0.8 Miles away, Heathrow Express Terminals 1, 2 & 3 Hatton Cross train station providing several links to central London and the surrounding. A number of highly regarded schools in the local area including Harlington school and Botwell House catholic primary school. Hounslow Treaty centre being a 16 minute drive away with its variety of local shops, restaurants and coffee shops.



Floor Plans

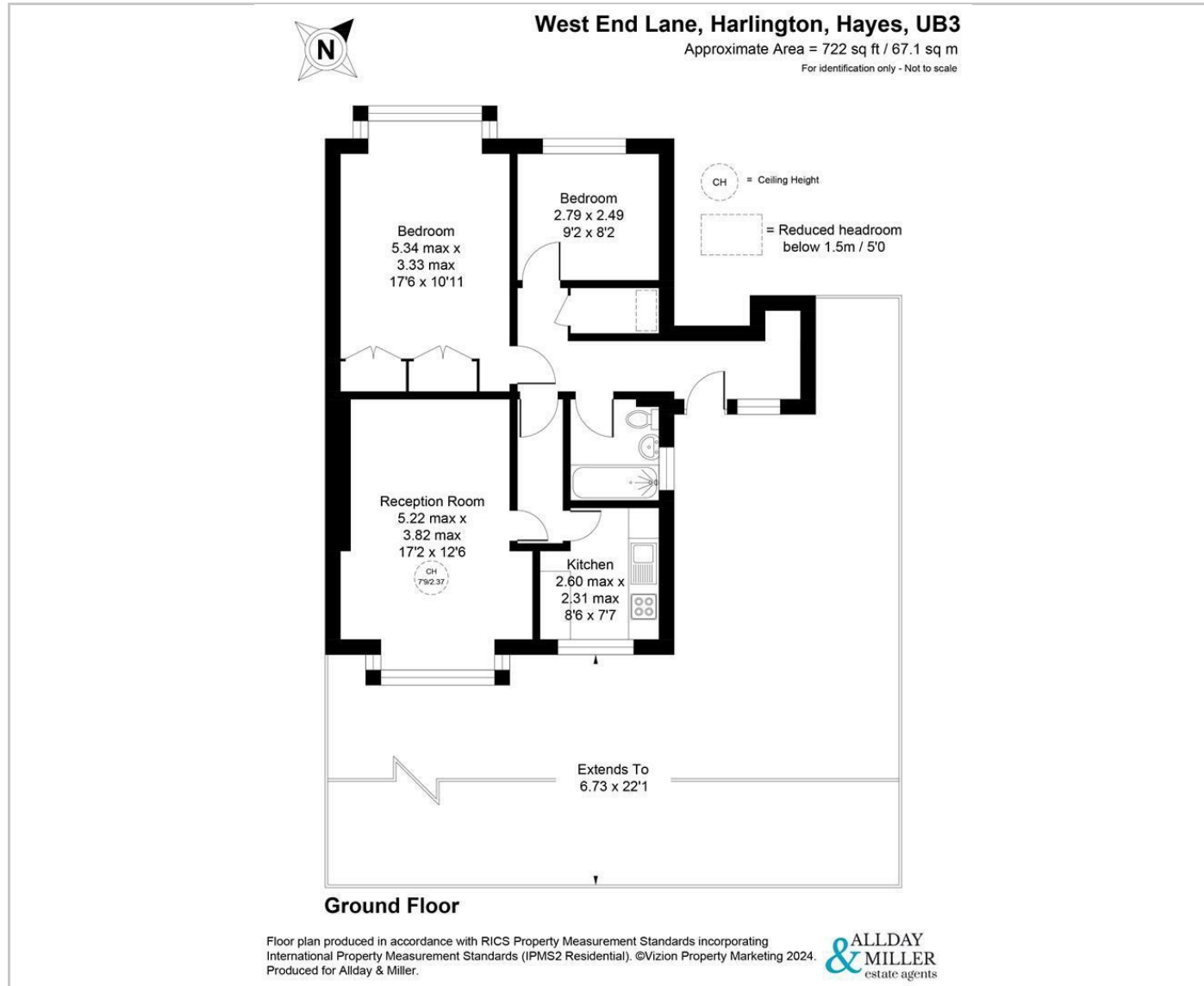

Area Map

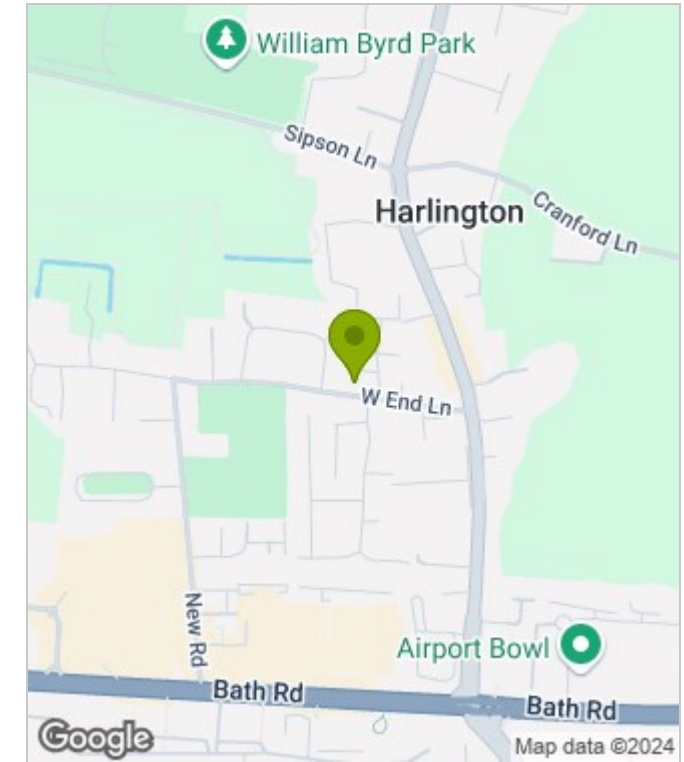

Energy Performance Graph

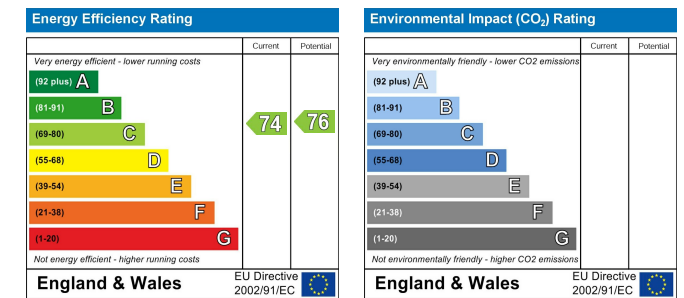

These particulars, whilst believed to be accurate are set out as a general outline only for guidance and do not constitute any part of an offer or contract. Intending purchasers should not rely on them as statements of representation of fact, but must satisfy themselves by inspection or otherwise as to their accuracy. No person in this firm's employment has the authority to make or give any representation or warranty in respect of the property.